

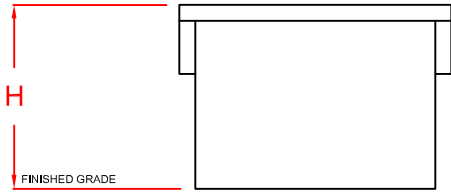

SEGUIN TOWNSHIP

ILLUSTRATIONS OF BUILDING HEIGHT



FRONT VIEW

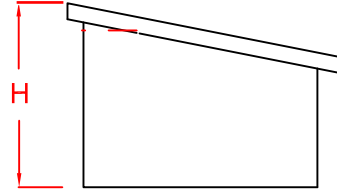

SIDE VIEW

SHED ROOF

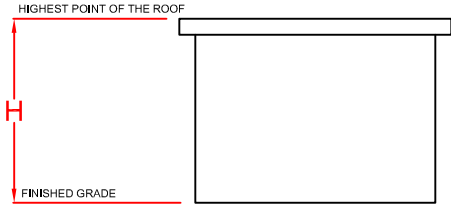

FRONT VIEW

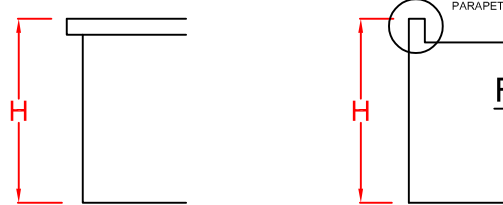

SIDE VIEW

FLAT ROOF

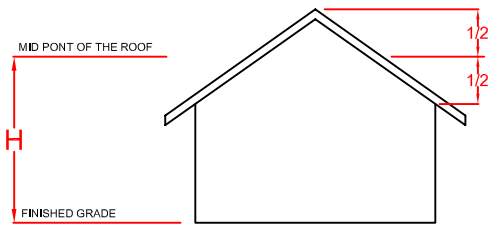

FRONT VIEW

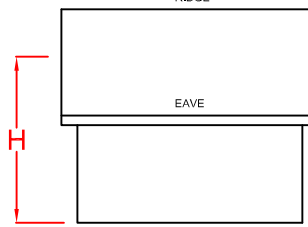

SIDE VIEW

GABLE ROOF

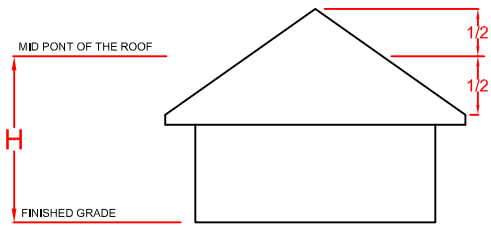

FRONT VIEW

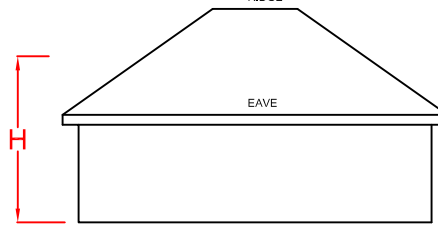

SIDE VIEW

HIP ROOF

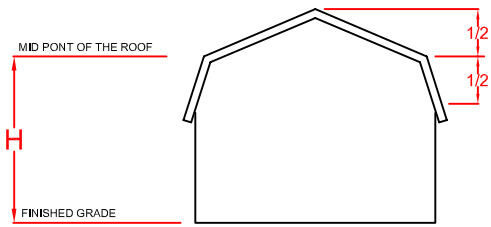

FRONT VIEW

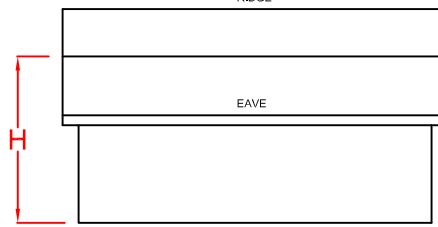

SIDE VIEW

GAMBREL ROOF

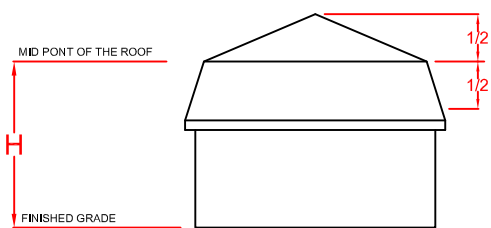

FRONT VIEW

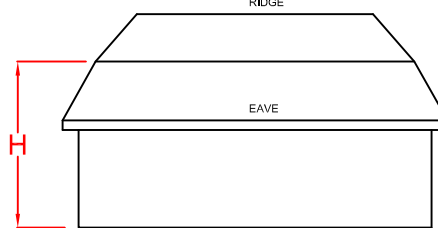

SIDE VIEW

MANSARD ROOF



SEGUIN TOWNSHIP

ILLUSTRATIONS OF BUILDING HEIGHT

1 STOREY BOATHOUSE

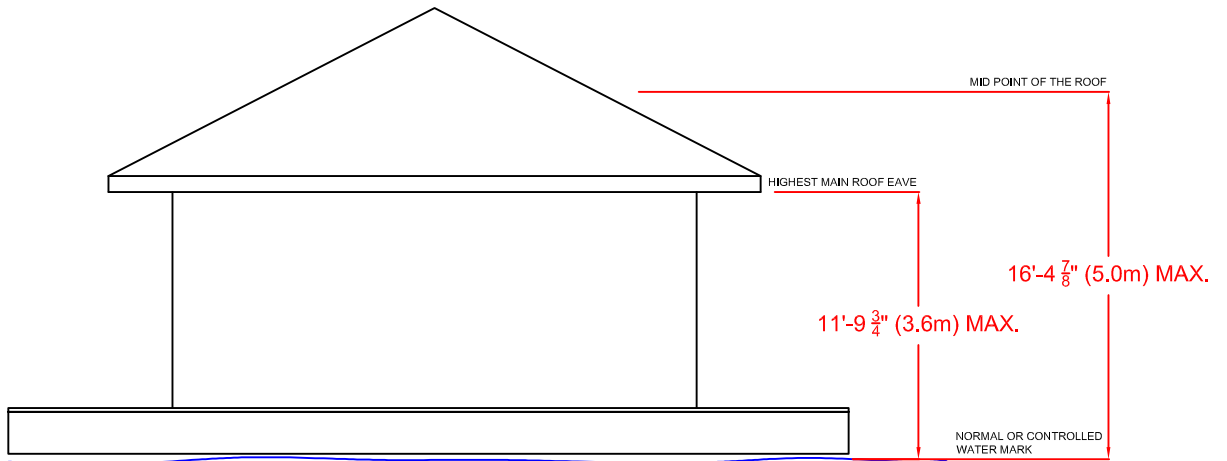

1.5 STOREY BOATHOUSE

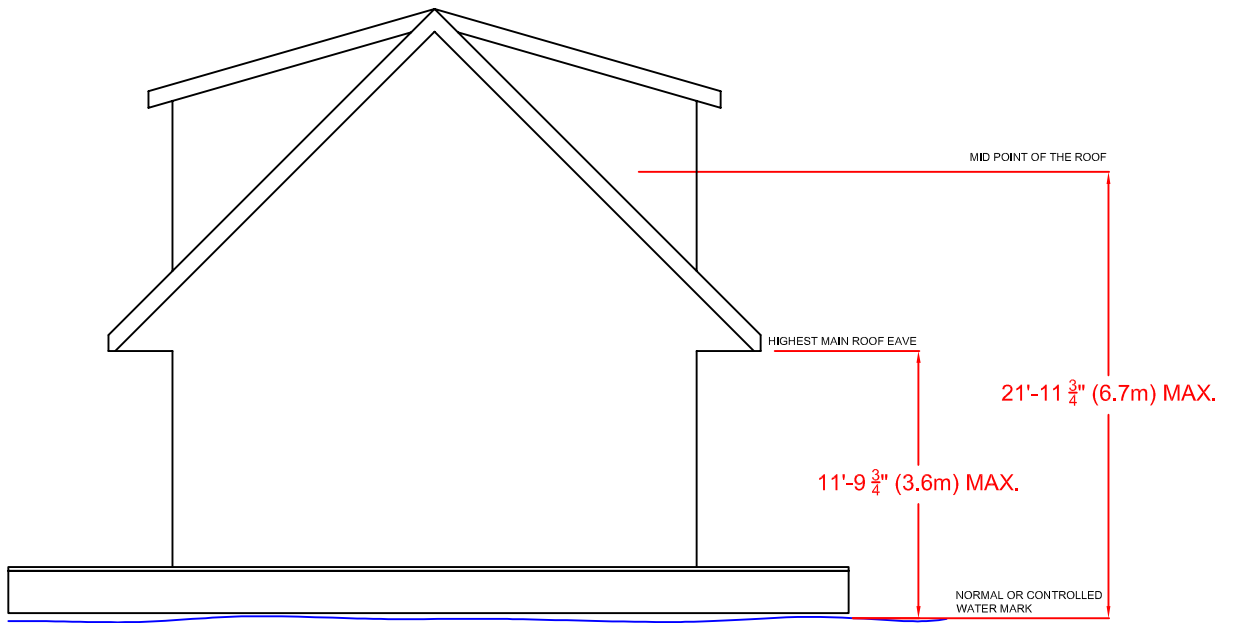

ROOF WITH DORMERS - VIEW PLAN

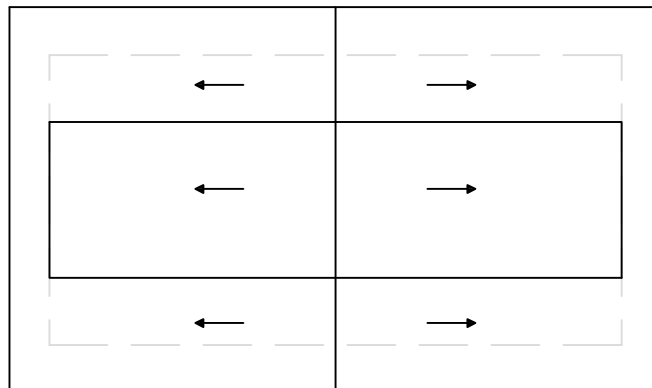

DORMER:
TYPE OF DORMERS ARE, HIPPED, SHED, EYEBROW AND GABLE.
WHERE A DORMER MAKE UP MORE THAN 50% OF THE ROOF PLANE,
THEY SHALL BE CONSIDERED THE MAIN ROOF. A RECESSED DORMER
SHALL NOT BE PERMITTED ON A BOATHOUSE



SEGUIN TOWNSHIP

ILLUSTRATIONS OF DEFINITIONS:

STOREY, HALF

MEANS THE PORTION OF A BUILDING SITUATED WITHIN THE ROOF OR HAVING ITS FLOOR LEVEL NOT LOWER THAN 4'-0" (1.2m) BELOW THE LINE WHERE THE ROOF/ DORMER AND EXTERIOR ENCLOSING WALLS MEET; AND WHEN USED WITH REFERENCE TO A ONE AND A HALF STOREY BOATHOUSE, MEANS THAT PORTION OF THE BOATHOUSE SITUATED BETWEEN A SLOPING ROOF AND A FLOOR ABOVE THE FIRST STOREY BELOW, OF A BOATHOUSE.

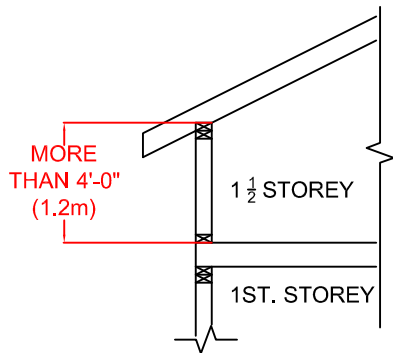
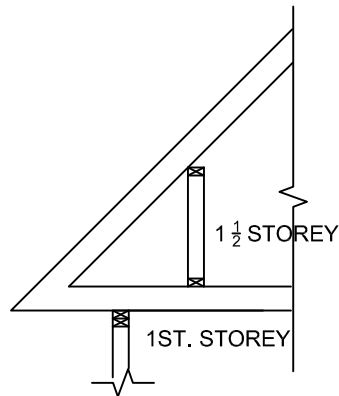
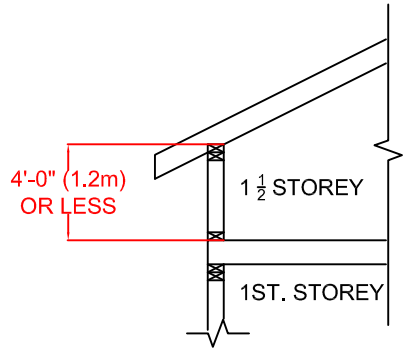



SEGUIN TOWNSHIP

ILLUSTRATIONS OF DOCK SITE PLAN AND REQUIREMENTS:

